

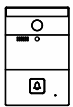

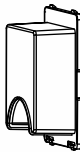

# DH-H80S Series Quick Guide

## 1 Preparation

## PREPARATION

Before the installation of the device, please check you have the following items on hand.

DH-H80S  ×1	Waterproof cover  ×1	Screw M4×30  ×4	Screw M3×4FMO  ×2	Wall bracket  ×1
---	--	--	--	--

## 2 Product Overview

## PRODUCT OVERVIEW

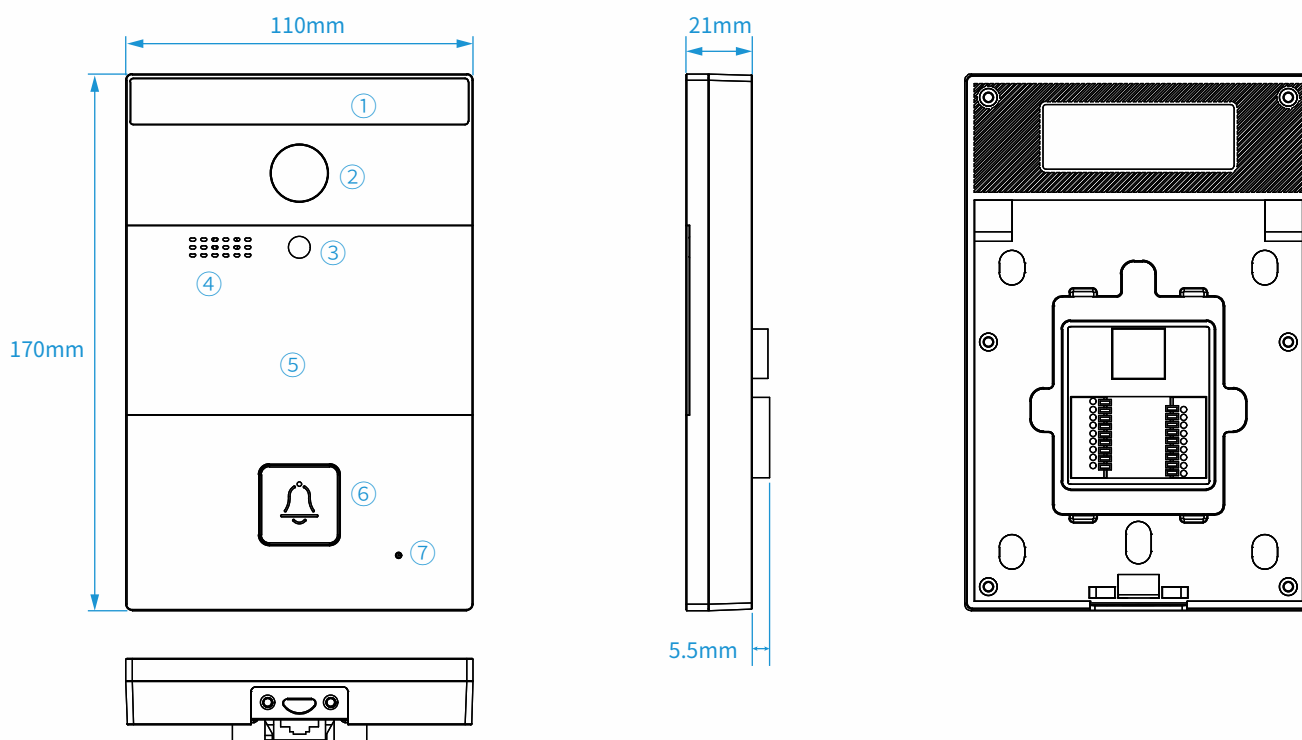

- |                   |                   |               |       |
|-------------------|-------------------|---------------|-------|
| ① White light LED | ③ Infrared sensor | ⑤ Card Reader | ⑦ Mic |
| ② RGB camera      | ④ Loudspeaker     | ⑥ Call button |       |

# DH-H80S Series Quick Guide

## 3 | Installation Environment

## INSTALLATION ENVIRONMENT

The device can be installed in both indoor and outdoor environment.

**Outdoor installation:** Avoid to exposing the device to direct sunlight, which will cause damage to device and components due to high temperature.

**Indoor installation:** The device should be installed on somewhere 2 meters (6 feet) away from light or 3 meters (9 feet) away from window/door.

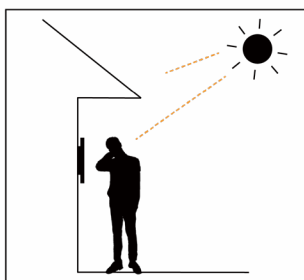

✗ Backlight

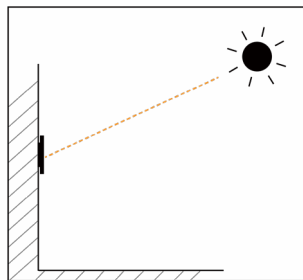

✗ Direct sunlight

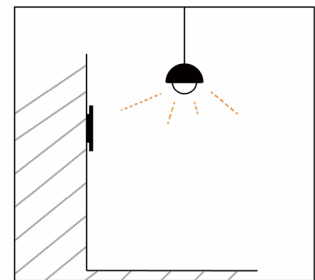

✗ Close to light

## 4 | Installation

## INSTALLATION

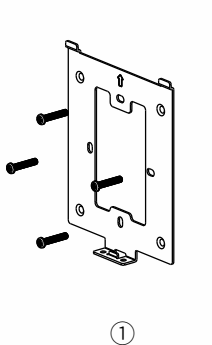

①

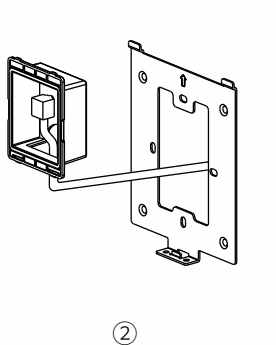

②

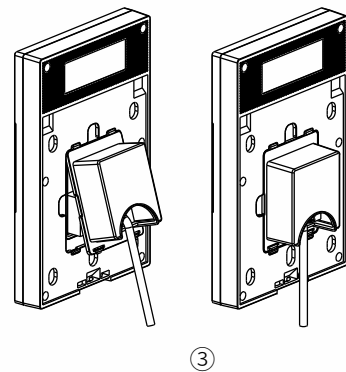

③

- ① Lock the wall bracket on the bottom box inside the wall with four M4×30 screws.
- ② Let all cables go through the wall bracket and then the waterproof cover, connect them to corresponding interfaces of device.
- ③ Attach the waterproof cover onto the device back panel by snap-fit.

# DH-H80S Series Quick Guide

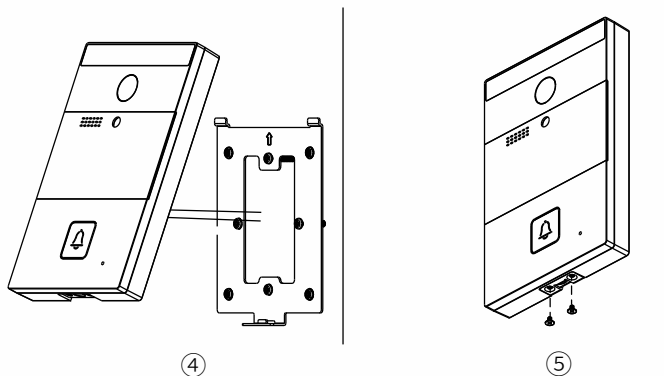

- ④ Attach the device with waterproof cover on the wall bracket.
- ⑤ Lock the device with wall bracket from the bottom by two M3×4FMO screws.

## 5 Interfaces

## INTERFACES

- Ethernet (PoE): Ethernet (PoE) connector which can provide both power and network connection.
- RS485+/RS458-/GND: Terminals for automation system control (e.g. Elevator control).
- OPEN/COM: Terminals for connecting to the cathode lock.
- CLOSE/COM: Terminals for connecting to anode lock or magnetic lock.
- D\_IN1/GND: Terminals for pressing indoor button to open relay.
- D\_IN2/GND: Terminals for Connecting to the door sensor.
- NC1: Default output high level, output low level when the indoor alarm is triggered.
- NC2/NC3: Reserved terminal, default output high level.
- WG\_D0/WG\_D1/GND: Terminals for wiegand access control.
- VCC\_WG: Terminal for wiegand device power supply.
- +12V/GND: External power supply terminal if PoE is not available.

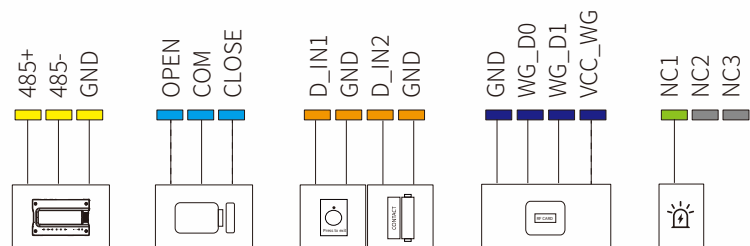
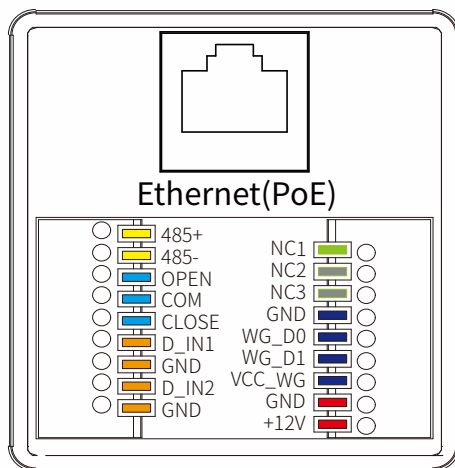

# DH-H80S Series Quick Guide

## 6 | Specifications

## SPECIFICATIONS

- OS: Linux
- Ethernet: 10M/100M adaptive
- Input power: DC12V / 1A
- PoE: 802.3af PoE
- IP level: IP65
- Front panel: Aluminum
- Working Temperature: -30°C ~70°C
- Working Humidity: 10%~95%RH
- Equipment size: 170×110×21mm
- Installation size: Wall-mounting

## 7 | Configurations

## CONFIGURATIONS

### • Check IP Address

Press on the device call button and hold for 5 secs, the device will broadcast the IP address digits by voice.

### • Set SIP Account

Log into Web configuration portal of device, set up and register SIP accounts in **INTERCOM-ACCOUNT** page. (You can refer to device user manual for more details)

### • Set DTMF Code

Select DTMF mode and configure the code in **SYSTEM-RELAY** page of Web configuration portal. (You can refer to device user manual for more details)

## 8 | Functions

## FUNCTIONS

### • Auto answer

Incoming calls to H80S will be answered automatically by default.

### • DTMF Unlock

Press the configured DTMF code on keypad of device answering the call, the lock connected on H80S will be unlocked remotely.

### • Card/Keyfob Unlock

Attach the saved access card or keyfob on the card reader area of H80S to unlock the door.

# DH-H80S Series Quick Guide

## 9 | Precautions

## PRECAUTIONS



- Violent vibration, collision and shock will cause damages to device.
- Intense direct sunlight will seriously affect the device performance and life span.
- Keep the access card/keyfob away from magnet and water. DO NOT fold or bend the card/keyfob.
- The height between camera and ground should be 1.5m (around 4ft 11in) to guarantee the ideal visual angle.

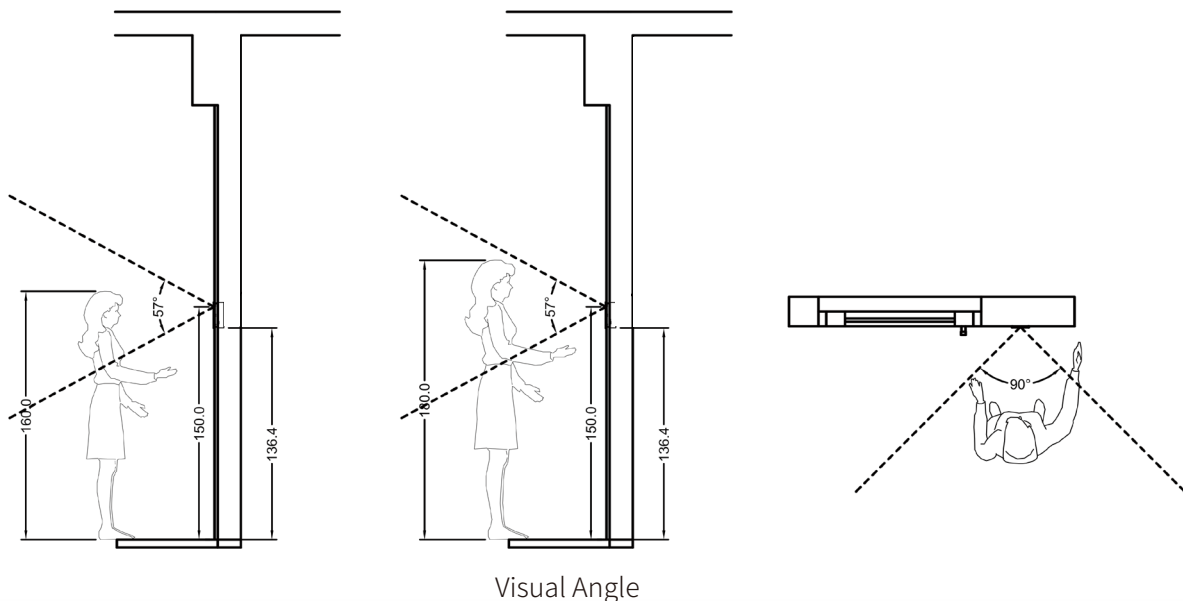

Visual Angle



### Notice Information

Information contained in this document is believed to be accurate and reliable at the time of printing. This document is subject to change without notice. The update version of this document can be viewed on NEXhome website: <http://www.nexhome.ai>  
©Copyright 2022 NEXhome Ltd. All rights reserved.

### Fujian Nexhome Intelligent Technology Co., Ltd.

Add.: No.33 Xingang Avenue, Shangjie, Minhou, Fuzhou, Fujian, 350108, China  
Web: [www.nexhome.ai](http://www.nexhome.ai)